

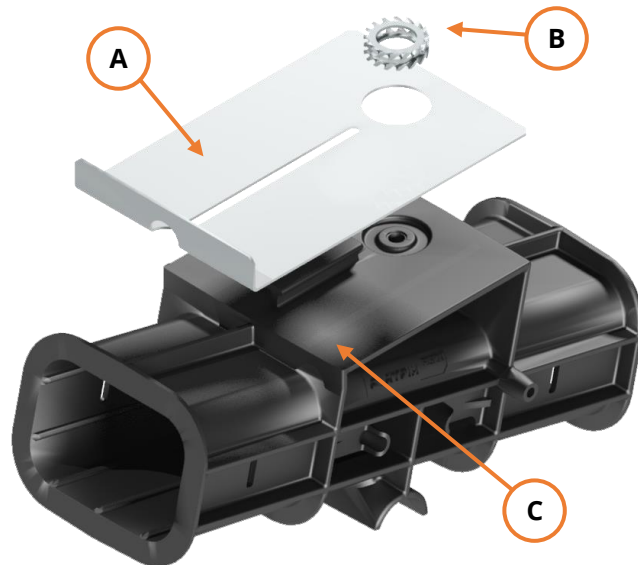

TEMPORARY ITEM: 100-7029 – EXTENSION PLATE DUAL

With this extension plate [A] it's possible to use Flatfix Fusion for installation with bigger PV modules in terms of module width. In case of dual configuration, or better known as east-west configuration, it was not possible to do so. East orientated module was in interference with the West orientated module.

To solve this for long term, a mould is in modification to replace the low rib. The extension plate is now added to our portfolio to solve this issue for projects in the coming months (temporary solution).



A quick manual is available. Installers have to remove the low rib structure [C] of the low base element to make it possible to add the extensionplate [A]. Because of the extra thickness, an extra grounding ring [B] needs to be placed to ensure a good functioning.

Maximum possible width PV Module	without extension plate	1000mm
Maximum possible width PV Module	with extension plate	1016mm

- Item A 100-7029 Extension plate (TEMPORARY)
- Item B 100-7501 Grounding ring
- Item C 100-7020 Base element low

INFORMATION AND PRICING

Available to order from 01-07-2018

Available for delivery from 20-07-2018

Art.no.	Description	Unit	Gross price	Weight (KG)	Intrastat code	VPE
100-7029	Extension plate dual	Pcs	€ 1,99	0,074	73269094	200

ESDEC
Londenstraat 16
7418 EE Deventer
The Netherlands

T +31 850 702 000
info@esdec.com
www.esdec.com

IBAN NL64 INGB 0658539531
BIC INGBNL2A
VAT NL813998955B01

